

8

7

6

5

4

3

2

1

FINAL ASSEMBLY

PART SYMMETRICAL  
ON CENTER LINE

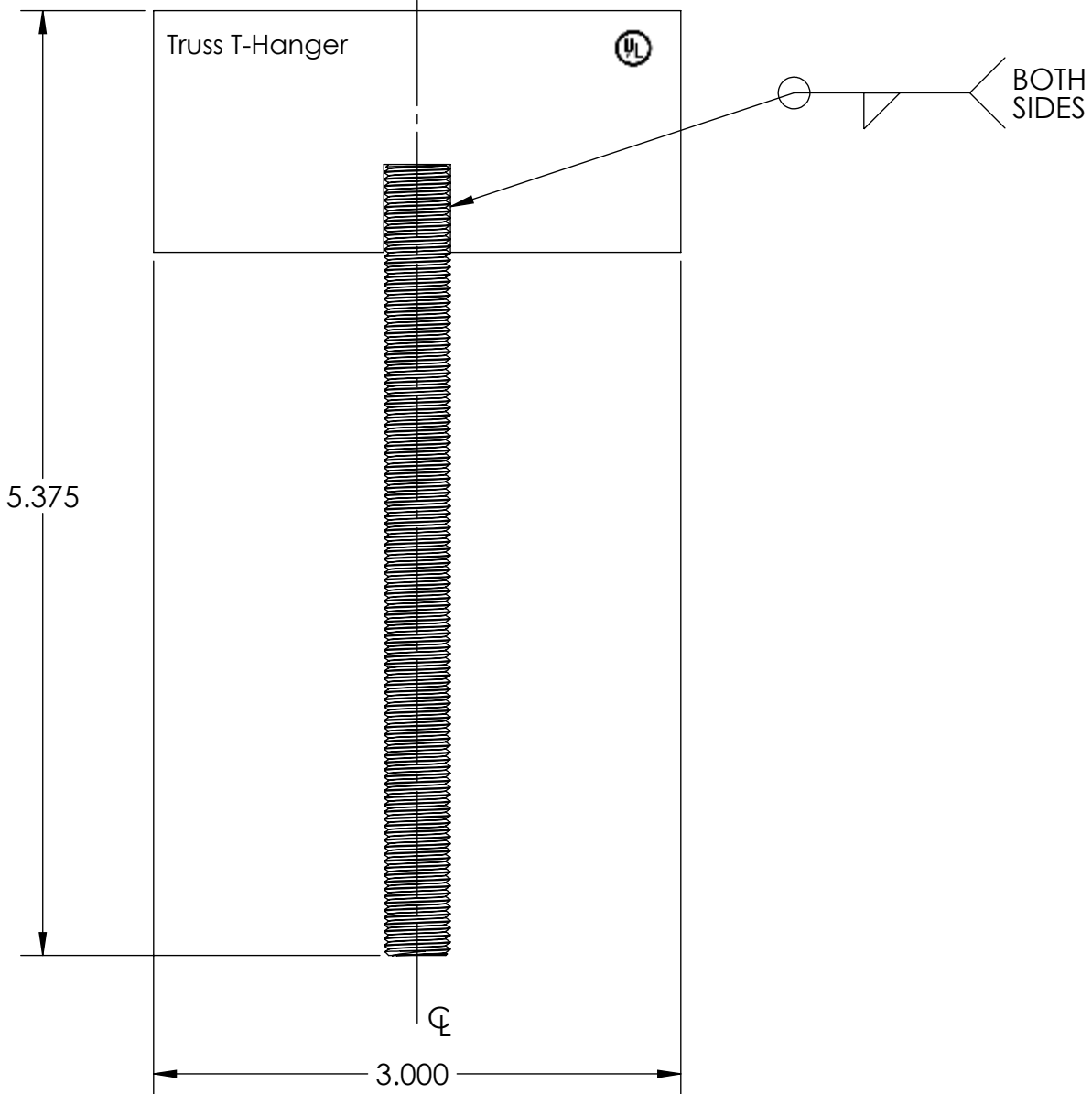

NOTES:  
 -ALL DIMENSIONS ARE IN INCHES  
 -TOLERANCE OF  $\pm .063$ "  
 -FINAL ASSEMBLY TO BE ZINC PLATED

D

C

B

A

PROJECT:		TRUSS T HANGER		DATE:	10-12-16	REV	A
DWG. NO.		.375 Top Cord Assembly.		NAME:	PW	REV	-
Sheet1		DRAWN	-	DATE:	10-12-16	DESCRIPTION	INITIAL RELEASE
SAM HARTWICK		REVIEWED	-	NAME:	-	SCALE: 1:1	8-15-17
PO BOX 57		G.A. APPR.	-	DATE:	-	SHEET 1 OF 3	RELEASE FOR PRODUCTION
MARSING, ID 83639		CLIENT APPR.	-	RELEASED TO MFG.	-		

8

7

6

5

4

3

2

1

D

C

B

A

8

7

6

5

4

3

2

1

PLATE

D

C

B

A

D

C

B

A

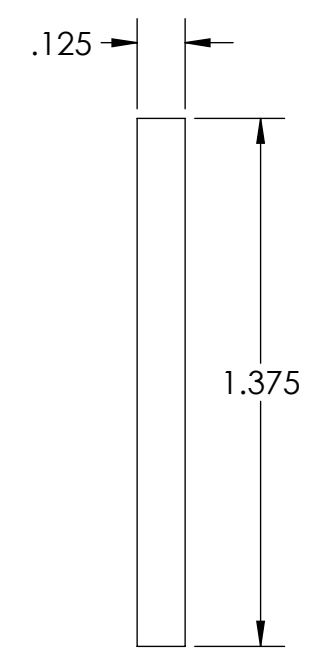
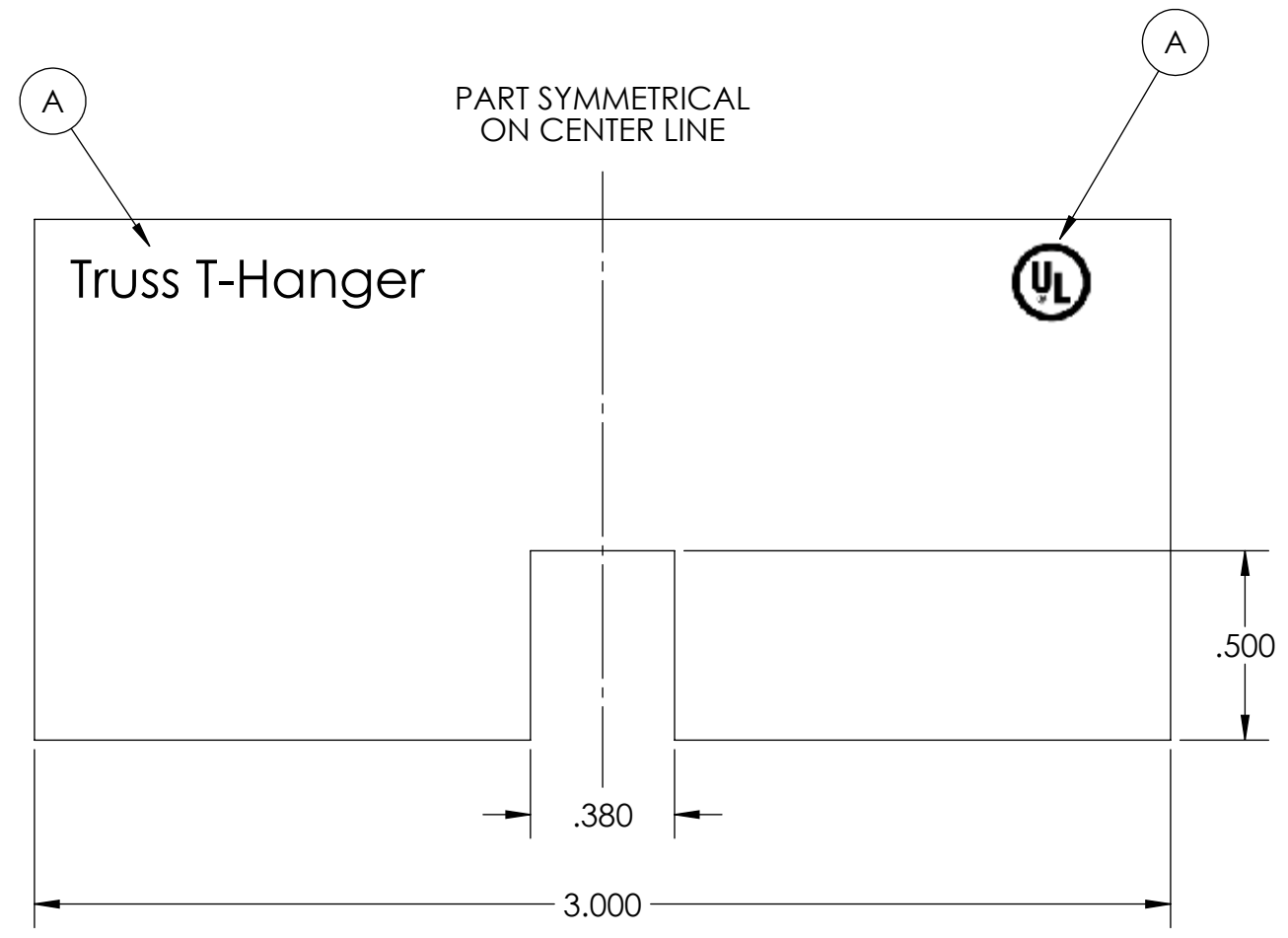

PART SYMMETRICAL  
ON CENTER LINE

Truss T-Hanger



NOTES:

MATERIAL: 10 GAUGE, A36 STEEL

**A** PART TO BE PERMANENTLY  
IDENTIFIED BY NAME AND UL  
LABEL AS SHOWN

PROJECT: <b>TRUSS T HANGER</b>		DRAWN	NAME:	DATE:	REV	REV	REV	REV
DWG. NO. 375 Top Cord Assembly.2		REVIEWED	PW	10-12-16	-	A	-	A
Sheet2		G.A. APPR.	-	-	10-12-16	INITIAL RELEASE	8-15-17	RELEASE FOR PRODUCTION
SAM HARTWICK PO BOX 57 MARSING, ID 83639		CLIENT APPR.	-	-	-	SCALE: 2:1	-	-
		RELEASED TO MFG.	-	-	-	SHEET 2 OF 3	-	-

8

7

6

5

4

3

2

1

THREADED ROD

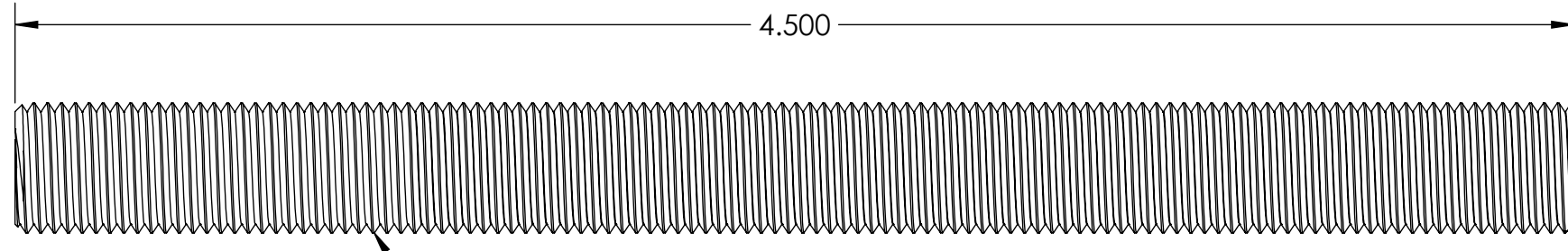

3/8" - 16, ALL THREAD ROD

GENERAL NOTES:  
 MATERIAL- STEEL A36  
 GRADE- A307 GRADE A  
 FINISH- NO PLATING/PLAIN  
 THREAD- RIGHT HAND, 3/8"-16  
 ALL DIMENSIONS IN INCHES

PROJECT:  
**TRUSS T HANGER**  
 DWG. NO.  
 375 Top Cord Assembly.3  
 Sheet3

SAM HARTWICK  
 PO BOX 57  
 MARSING, ID 83639

REV	DATE	DESCRIPTION
-	10-12-16	INITIAL RELEASE
A	8-15-17	RELEASE FOR PRODUCTION

SIZE	REV
<b>B</b>	<b>A</b>

NAME:	DATE:
PW	10-12-16
-	-
-	-
-	-
-	-

DRAWN	REVIEWED	G.A. APPR.	CLIENT APPR.	RELEASED TO MFG.

SCALE:	SHEET
2:1	3 OF 3

D

C

B

A

D

C

B

A